

Drain Master

1 ½ Installation Instructions

Installing Drain Master in a 1 ½" plumbing line is very simple. Your reducer kit contains all of the necessary parts required.

1. To connect Drain Master to your existing 1 ½" ABS pipe, first determine the Drain Master location in the 1 ½" pipe. Refer to the installation instructions for details and precautions. You will need 2" of space between the ends of your 1 ½" pipe to glue the two flange reducers to. (See figure1)

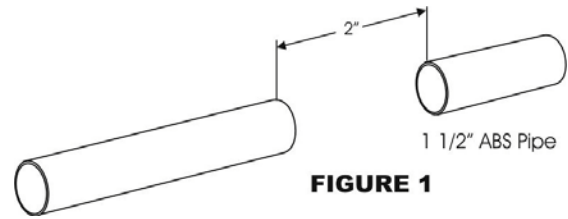

2. Connect the flange reducers to the Drain Master and hold the unit between the two pipe ends to insure correct spacing.
3. Remove the flanges and glue one reducer flange to either the left or right pipe. **NOTE: Make sure flange is centered on the pipe with the 1 ½" hole at the lowest point.** (See figure 3)

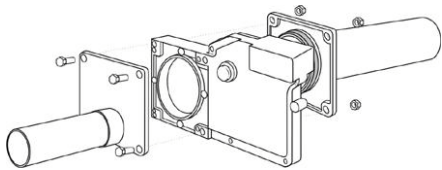
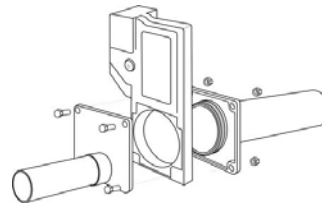

FIGURE 3



4. Put Drain Master in place against the glued reducer flange and check alignment. When the other flange reducer is glued in place, the four bolt holes must be aligned. (See figure 3)
5. Glue the second flange reducer to remaining 1 ½" pipe.
6. Install the two flange seals on the flange reducers.
7. Slip the Drain Master into position between the seals and push piping together.
8. Insert the four bolts and self locking nuts and tighten. Check for leaks by filling gray water tank with water.
9. Wire switch and operate valve. (Instructions for wiring switch are in the Drain Master Installation Instructions)

Any questions, call toll free (877) 787-8833 and one of our technical service reps will help you promptly. Thank you for purchasing another quality product from Phase Four Industries.